

## CONNECT TO BATTERY

Using the Battery Terminal Adapter Connect:

1. Battery Terminal Adapter to Remote Switch Box
2. RED Wire Terminal to the Battery Positive (+)
3. BLACK Wire Terminal to the Battery Negative (-)

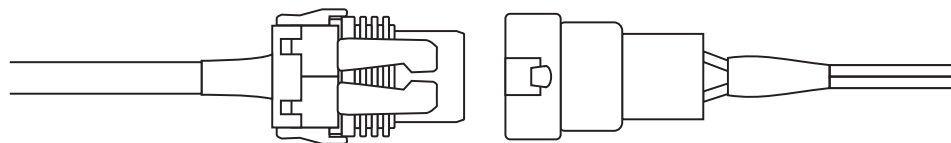

Battery Terminal Adapter

Remote Switch Box

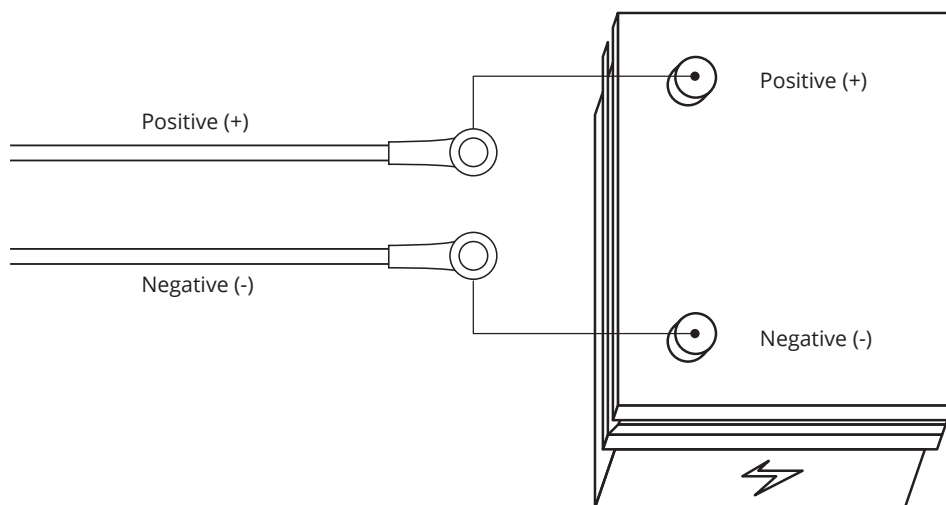

# REMOTE CONTROL LIGHT BAR HARNESS

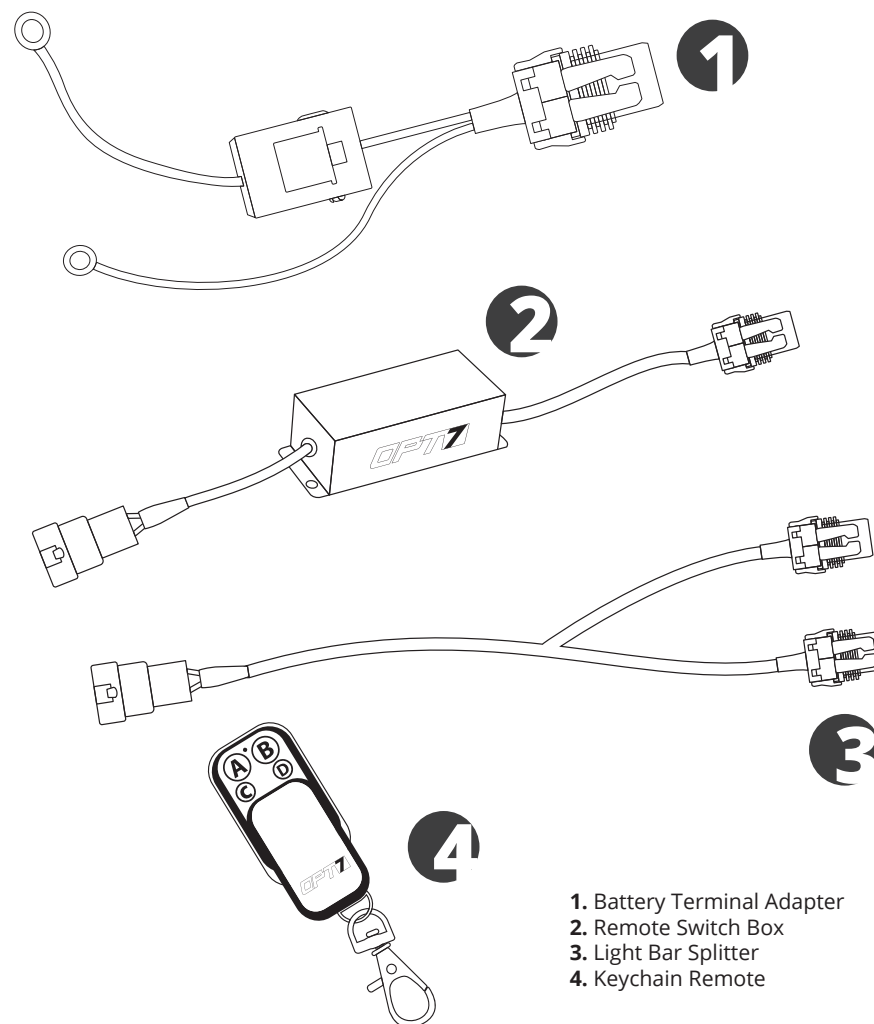

1. Battery Terminal Adapter
2. Remote Switch Box
3. Light Bar Splitter
4. Keychain Remote

## REMOTE OVERVIEW

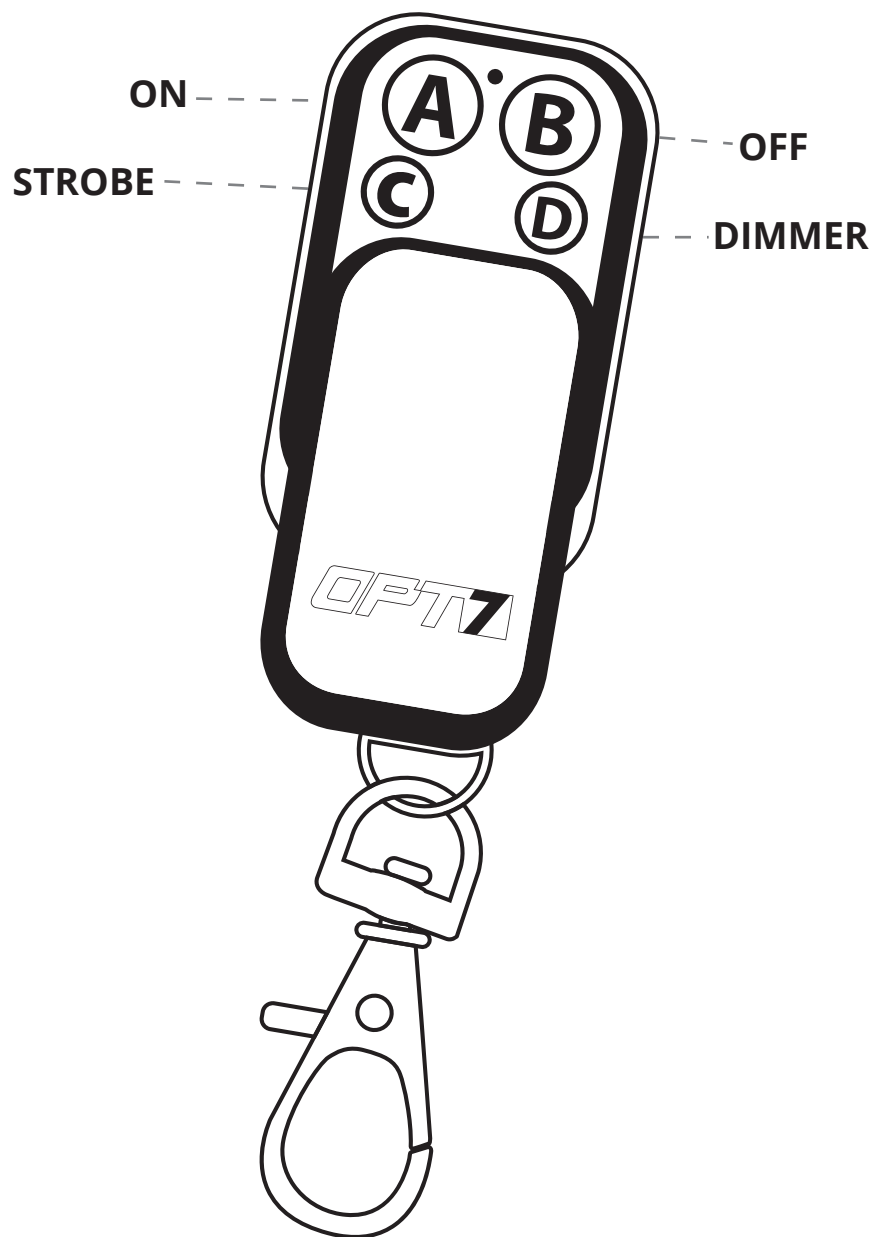

## CRIMPING ON THE CONNECTORS TO LIGHT BAR

1

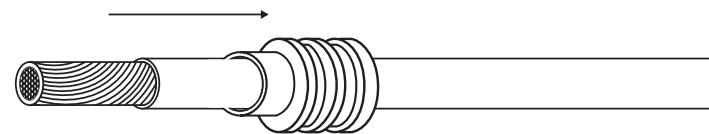

2

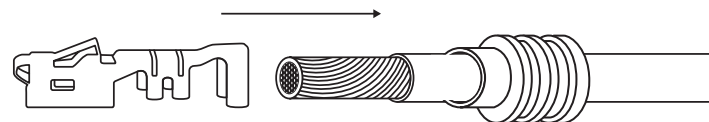

3

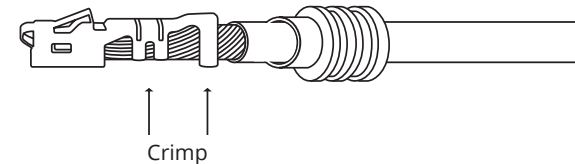

4

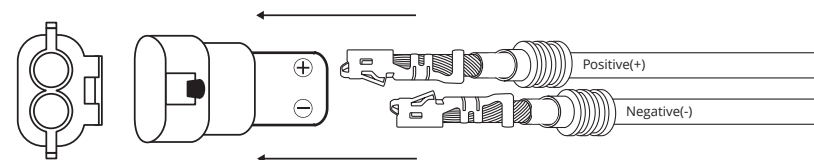

**4a.** Face the connector up as indicated by the black clip in the diagram.

**4b.** Insert crimped wires into connector: **TOP:** Positive (+) **BOTTOM:** Negative (-)

**4c.** Push the rubber plug into the connector to seal out water.

5

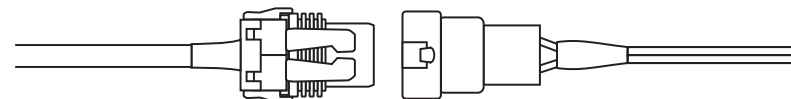

Remote Switch Box

Light Bar Splitter